



PGP Universal™ Gateway Email 2.9

Secure email communications without client software

Part of the PGP® Encryption Platform

Benefits

- **Easy, automatic operation** – Protects sensitive email without changing the user experience.
- **Enforced security policies** – Automatically enforce data protection with centrally managed policies.
- **Accelerated deployment** – Achieves end-to-end email encryption using the existing infrastructure.
- **Reduced operation costs** – Result from eliminating training and help desk costs through clientless operation.

PGP Customer Spotlight

Harvard Pilgrim Health Care, a leading health insurance provider, chose PGP Universal™ Gateway Email to help comply with data privacy regulations because it was easy to deploy, easy to use, and inexpensive to operate.

Protect email confidentiality with centrally defined and enforced encryption policy

Email has evolved into the most important business communications system in the world, enabling organizations to efficiently interact with customers, clients, and business partners. Unfortunately, unprotected email poses a critical risk to an enterprise's most sensitive data: customer information, financial data, trade secrets, and other proprietary information. Exposure of this information can result in financial loss, legal ramifications, and brand damage.

PGP Universal Gateway Email provides centrally managed, standards-based email encryption to secure email communications with customers and partners. By encrypting data at the gateway, PGP Universal Gateway Email ensures data is protected from unauthorized access in transit over the public Internet and at rest on a recipient's mail server. With PGP Universal Gateway Email, organizations can minimize the risk of a data breach and comply with partner and regulatory mandates for information security and privacy.

Gateway-Based Email Encryption

PGP Universal Gateway Email secures email messages automatically as they leave the enterprise network according to highly configurable encryption rules, eliminating the need for client software or user intervention. Flexible delivery options allow an organization to integrate seamlessly with partners' existing standards-based email encryption solutions or to securely deliver messages to partners and customers that lack an email encryption solution.

PGP Encryption Platform–Enabled

PGP Universal Gateway Email is a PGP Encryption Platform–enabled application. The PGP Encryption Platform provides a strategic enterprise encryption framework for shared user management, policy, and provisioning, automated across multiple, integrated encryption applications. As a PGP Encryption Platform–enabled application, PGP Universal Gateway Email can be used with PGP Universal™ Server to manage existing policies, users, keys, and configurations, expediting deployment and policy enforcement. PGP Universal Gateway Email can also be used in combination with other PGP encryption applications to provide multiple layers of security.

Easy, Automatic Operation

Once PGP Universal Gateway Email is deployed, its operation is completely transparent—users simply continue to work as usual. The software automatically provides secure delivery for outgoing messages according to policy, without changing internal end-user behavior, workflow, or productivity. Users are automatically enrolled using the existing infrastructure.

- **Flexible, secure delivery options** – Provides encrypted PDF or Web-email interface (Web Messenger) for securely delivering messages to external users that lack an email encryption solution.
- **PDF Messenger** – Delivers messages to partners as encrypted PDFs, eliminating the need for special software.
- **Certified Delivery** – Allows organizations to track and verify delivery of PDF Messenger–delivered messages.
- **Standards support** – Interoperates with existing OpenPGP or S/MIME-based solutions to secure email to partners.

Enforced Security Policies

Security policy configured in PGP Universal Server automatically triggers encryption based on content, sender, recipient, and other message details that identify confidential information.

Accelerated Deployment

Used together, PGP Universal Gateway Email and PGP Universal Server's unified management console establish, enforce, and update security policy in real time. This combination reduces the time and effort required to deploy email encryption.

- **Branding support** – Allows organizations to customize the Web-based delivery mechanism to reflect their brand.
- **Clientless operation** – Eliminates impact on senders and does not require partners to invest in new software, hardware, or training.
- **Automated user enrollment** – Makes account creation and key management automatic and transparent to end users.

PGP and the PGP logo are registered trademarks of PGP Corporation. Product and brand names used in the document may be trademarks or registered trademarks of their respective owners. Any such trademarks or registered trademarks are the sole property of their respective owners.

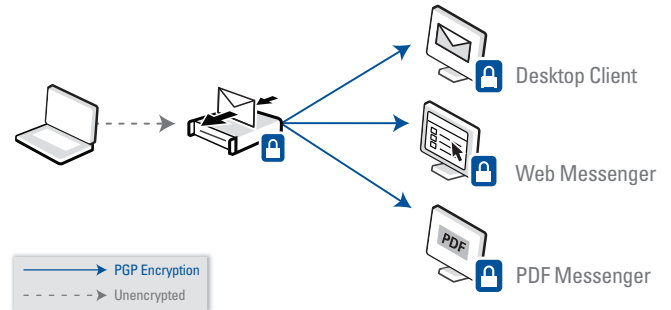

Multiple secure delivery options, including clientless delivery.

Reduced Operation Costs

With PGP Universal Gateway Email, no special training is required for end users. This approach accelerates deployment time, reduces training costs, and avoids any increase in help desk calls. PGP Universal Gateway Email allows organizations to:

- **Adapt to evolving security requirements** – Allows administrators to quickly implement new policies to control mail flow and encryption.
- **Leverage existing compliance investments** – Integrates with leading third-party email hygiene and outbound content compliance solutions to act on existing policies and processes.

PGP Universal Server Management

PGP Universal Gateway Email is centrally deployed and managed using PGP Universal Server, enabling organizations to easily set and enforce data security policies throughout the enterprise.

- **Centrally enforced security policy** – Automatically enforces protection of sensitive data and email using security policies driven by an existing corporate directory.
- **Extensible protection** – Allows management of PGP® Whole Disk Encryption, PGP® NetShare, or any other PGP Encryption Platform–enabled application.

Technical Specifications

PGP Universal Gateway Email runs on PGP Universal Server. For complete technical specifications, please visit www.pgp.com.



PGP Corporation
www.pgp.com

PGP Corporate Headquarters
Tel: +1 650 319 9000

PGP (GB) Ltd.
Tel: +44 (0)20 8606 6000

PGP Deutschland AG
Tel: +49 69 838310 0

PGP Japan K.K.
Tel: +81 03 4360 8308

© 2008 PGP Corporation
UNGEDS080811